



COMFORT  
REDEFINED

**Arroll**<sup>®</sup>







# QUALITY REDEFINED

Investing in an Arroll cast iron bath is an easy way to add elegance and glamour to your bathroom. Choose from our large range of exquisite designs, made with craft and precision, that will complement all kinds of interior styles.

It’s not all about aesthetics. Choosing an Arroll cast iron bath makes sense for lots of reasons. Our baths provide a focal point for the bathroom. Highly resilient against scratches, chemicals or detergents, they maintain their shape bath after bath, are easy to clean, offer protection against bacteria and are 100% recyclable.

At Arroll, we remain true to the skill of the master craftsmen that passed their knowledge and expertise from one generation to the next. Our bathtubs are produced using the advanced “V” vacuum process that uses natural unspoiled sand for mould processing. They are crafted and glazed to the same high standards and meticulous attention to detail that were so commonplace in the original artisan foundries.

And we are determined to keep those traditons alive. In today’s world where so many products are cheaply made, Arroll cast iron baths represent a move back to beautiful and functional furniture that are made to last – furniture your grandchildren will enjoy.

B-71-1 THE MILAN



<b>Size</b>	<b>Feet</b>
1800 × 790 × 705 mm	Chrome - Colour options available
<b>Material</b>	<b>Options</b>
Enamelled cast iron	Two tap holes / No tap holes
<b>Standard Finish</b>	<b>Weight</b>
White Primer Exterior	135 KG
<b>Finish Options</b>	<b>Water Capacity</b>
RAL or Colour Match	225 L

B-88 / B-88 (1700) THE BORDEAUX



<b>Size</b>	<b>Feet</b>
1560 × 780 × 735 mm 1700 × 780 × 735 mm	Chrome - Colour options available
<b>Material</b>	<b>Options</b>
Enamelled cast iron	Two tap holes / No tap holes
<b>Standard Finish</b>	<b>Weight</b>
White Primer Exterior	115 KG / 120 KG
<b>Finish Options</b>	<b>Water Capacity</b>
RAL or Colour Match	160 L / 170 L

B-89-2 THE CHAUMONT



<b>Size</b>	<b>Options</b>
1700 × 770 × 585 mm	Two tap holes / No tap holes
<b>Material</b>	<b>Weight</b>
Enamelled cast iron	260 KG
<b>Standard Finish</b>	<b>Water Capacity</b>
White Primer Exterior	200 L
<b>Finish Options</b>	
RAL or Colour Match	

B-89 / B-89 (1900) THE MOULIN



<b>Size</b>	<b>Feet</b>
1700 × 770 × 580 mm 1900 × 770 × 450 mm	Chrome - Colour options available
<b>Material</b>	<b>Options</b>
Enamelled cast iron	Two tap holes / No tap holes
<b>Standard Finish</b>	<b>Weight</b>
White Primer Exterior	135 KG / 145 KG
<b>Finish Options</b>	<b>Water Capacity</b>
RAL or Colour Match	200 L / 235 L

B-89-1 THE CHEVERNY



<b>Size</b>	<b>Feet</b>
1850 × 770 × 745 mm	Chrome - Colour options available
<b>Material</b>	<b>Options</b>
Enamelled cast iron	Two tap holes / No tap holes
<b>Standard Finish</b>	<b>Weight</b>
White Primer Exterior	190KG
<b>Finish Options</b>	<b>Water Capacity</b>
RAL or Colour Match	285 L

B-76-1 THE LYON



<b>Size</b>	<b>Options</b>
1700 × 720 × 725 mm	No tap holes
<b>Material</b>	<b>Weight</b>
Enamelled cast iron	200 KG
<b>Standard Finish</b>	<b>Water Capacity</b>
White Primer Exterior	215 L
<b>Finish Options</b>	
RAL or Colour Match	

B-71 THE VERSAILLES



<b>Size</b>	<b>Options</b>
1800 × 790 × 650 mm	Two tap holes / No tap holes
<b>Material</b>	<b>Weight</b>
Enamelled cast iron	193 KG
<b>Standard Finish</b>	<b>Water Capacity</b>
White Primer Exterior	255 L
<b>Finish Options</b>	
RAL or Colour Match	

B-83 THE VILLANDRY



<b>Size</b>	<b>Options</b>
1820 × 762 × 785 mm	Two tap holes / No tap holes
<b>Material</b>	<b>Weight</b>
Enamelled cast iron	142 KG
<b>Standard Finish</b>	<b>Water Capacity</b>
White Primer Exterior	190 L
<b>Finish Options</b>	
RAL or Colour Match	

APB-70 / APB-70 (1470) THE  
AMBROSE



<b>Size</b>	<b>Feet</b>
1370 × 740 x 740 mm 1470 × 740 x 740 mm	Chrome - Colour options available
<b>Material</b>	<b>Options</b>
Enamelled cast iron	No tap holes
<b>Standard Finish</b>	<b>Weight</b>
White Primer Exterior	130 KG / 140 KG
<b>Finish Options</b>	<b>Water Capacity</b>
RAL or Colour Match	160 L / 175 L

ALL MEASUREMENTS AND SIZES  
ARE APPROXIMATE AND SHOULD  
ONLY BE USED AS A GUIDE WITH A  
TOLERANCE LEVEL OF +/- 4MM.

**B-71-1** THE MILAN

The graceful lines of this classic roll top bath captures the subtle elegance of a bygone era. The freestanding ornate claw feet provide just the right amount of drama and look stunning in an open, loft style residence where the Milan looks especially sensational in a painted finish.



**B-71-1** THE MILAN TECHNICAL SPECIFICATION

BATHTUB	
Size:	1800 × 790 × 705 mm
Material:	Enamelled cast iron
Standard Finish:	White Primer Exterior
Finish Options:	RAL or Colour Match
Feet:	Chrome - Options Available
Options:	Two tap holes / No tap holes
Weight:	135 KG
Water Capacity:	225 L

\*All measurements and sizes are approximate.

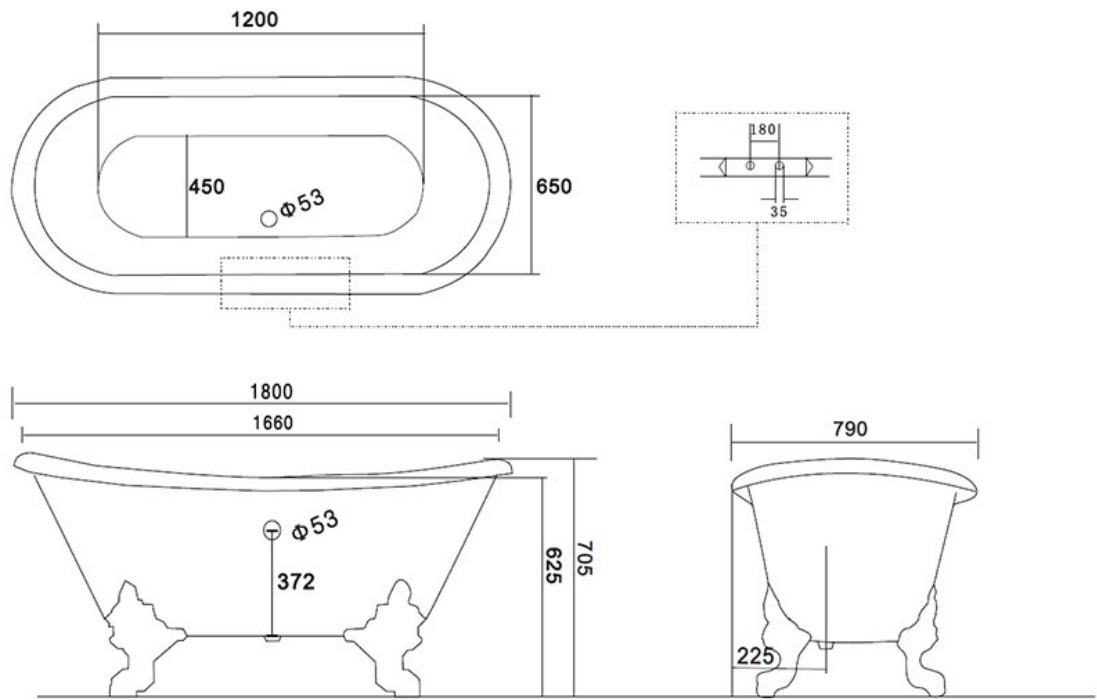



B-71-1 THE MILAN





**B-88 / B-88 (1700) THE BORDEAUX**

The Bordeaux, single ended slipper bath is the ultimate in luxurious relaxation. Ideal for sitting up and reading or simply bathing by candlelight, its beautiful proportions allow you to soak away the stresses of the day. Its ball and claw feet finish the look to adorn any kind of space or style.



**B-88 THE BORDEAUX TECHNICAL SPECIFICATION**

BATHTUB	
Size:	1560 × 780 × 735 mm
Material:	Enamelled cast iron
Standard Finish:	White Primer Exterior
Finish Options:	RAL or Colour Match
Feet:	Chrome - Options Available
Options:	Two tap holes / No tap holes
Weight:	115 KG
Water Capacity:	160 L

\*All measurements and sizes are approximate.

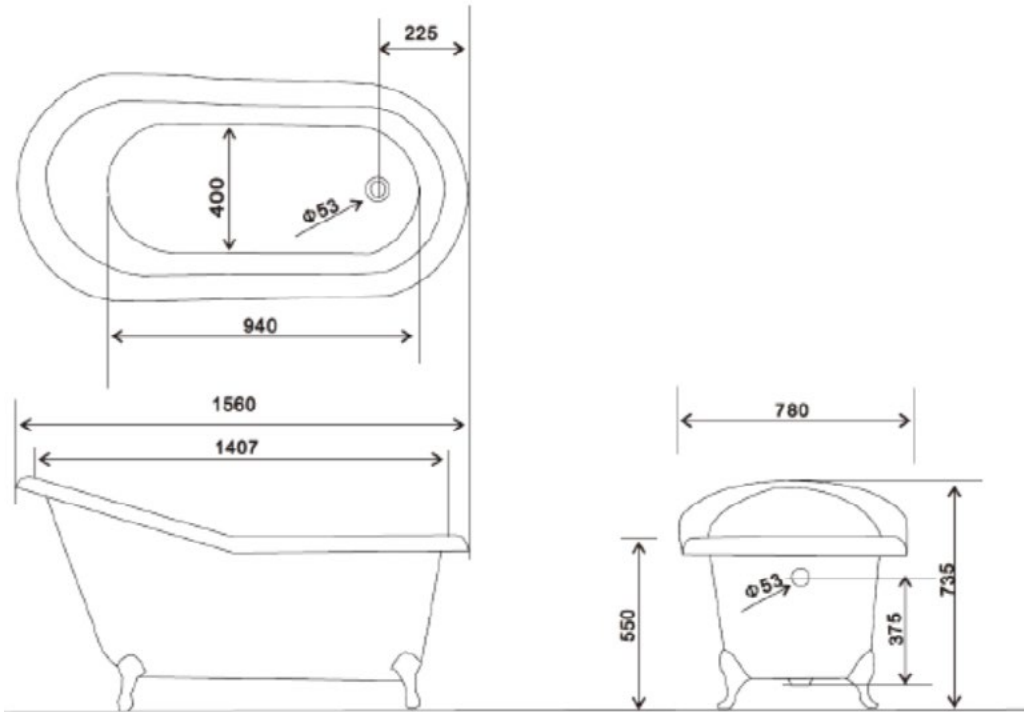

**B-88 (1700) THE BORDEAUX TECHNICAL SPECIFICATION**

BATHTUB	
Size:	1700 × 780 × 735 mm
Material:	Enamelled cast iron
Standard Finish:	White Primer Exterior
Finish Options:	RAL or Colour Match
Feet:	Chrome - Options Available
Options:	Two tap holes / No tap holes
Weight:	120 KG
Water Capacity:	170 L

\*All measurements and sizes are approximate.

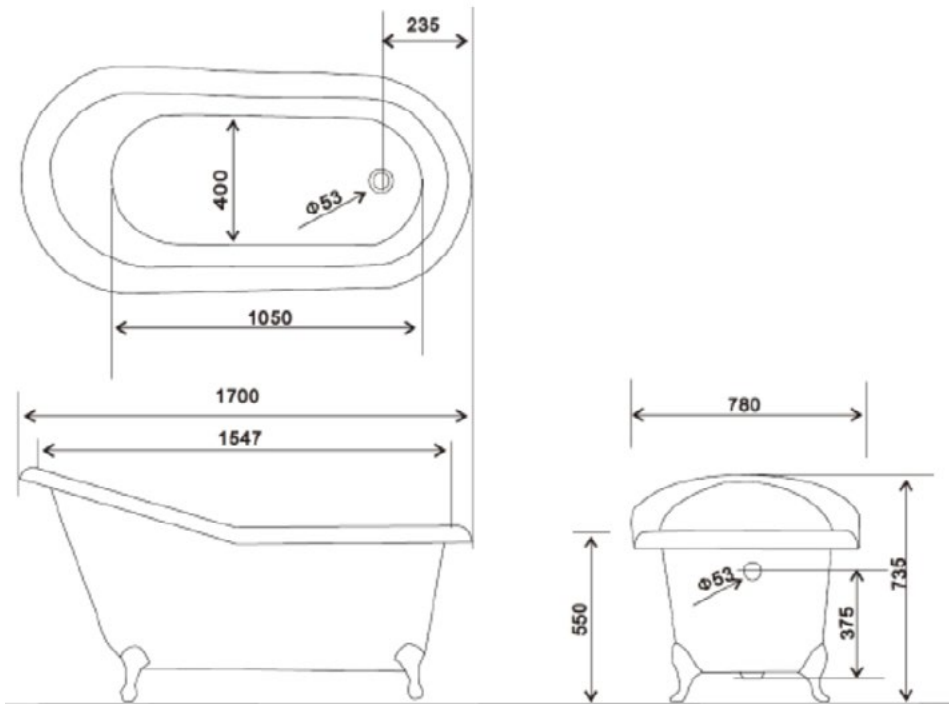



B-88, B-88 (1700) THE BORDEAUX





**B-89-2 THE CHAUMONT**

Generously proportioned for sipping Champagne á deux, this elegant plinth bath is inspired by the charm and decadence of the roaring 1920’s. Art Deco in style, the Chaumont cast iron bath adds instant sophistication to contemporary bathrooms.

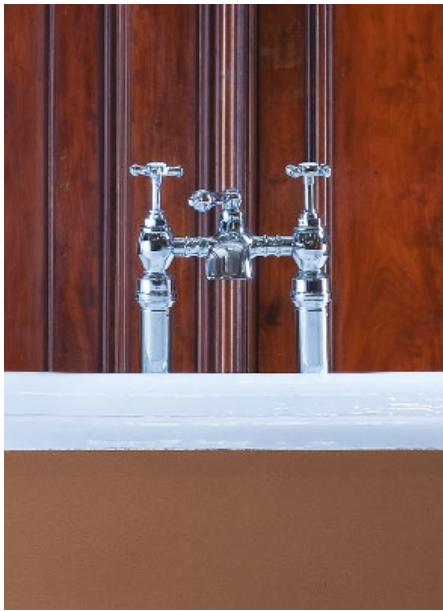

**B-89-2 THE CHAUMONT TECHNICAL SPECIFICATION**

BATHTUB	
Size:	1700 × 770 × 585 mm
Material:	Enamelled cast iron
Standard Finish:	White Primer Exterior
Finish Options:	RAL or Colour Match
Options:	Two tap holes / No tap holes
Weight:	260 KG
Water Capacity:	200 L

\*All measurements and sizes are approximate.

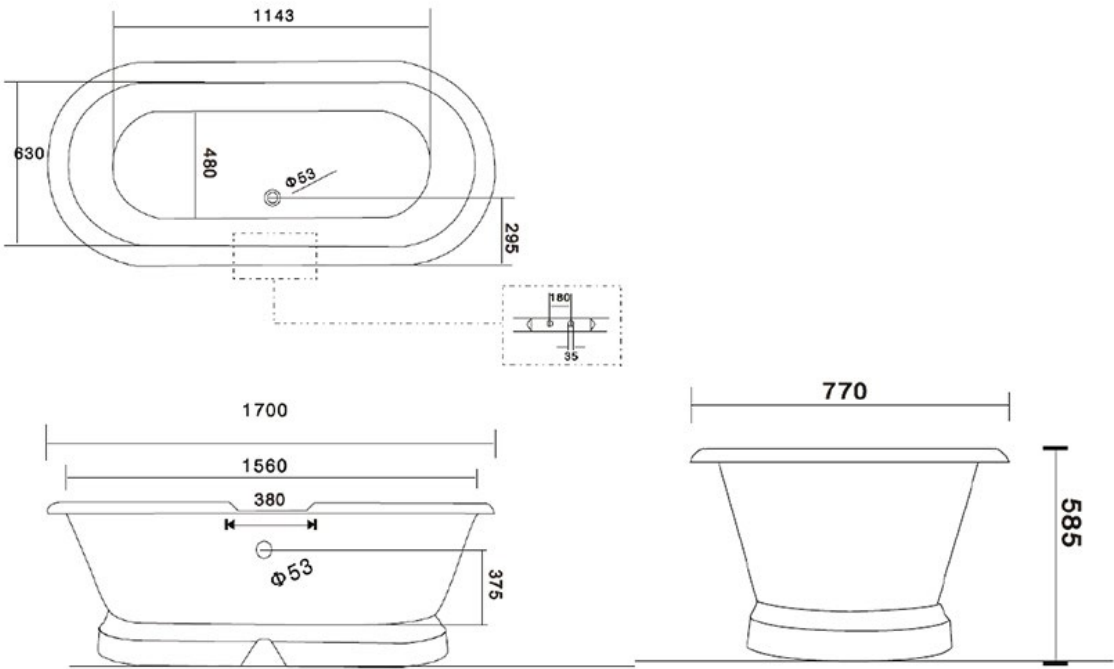



B-89-2 THE CHAUMONT





**B-89 / B-89 (1900) THE MOULIN**

The Moulin is a classic roll top and is our largest cast iron bath. The luxurious deep lines of this bath will soon have your worries floating away. The detailed feet available in chrome as standard, make it the ideal statement piece for your bathroom.



**B-89 THE MOULIN TECHNICAL SPECIFICATION**

BATHTUB	
Size:	1700 × 770 × 580 mm
Material:	Enamelled cast iron
Standard Finish:	White Primer Exterior
Finish Options:	RAL or Colour Match
Feet:	Chrome - Options Available
Options:	Two tap holes / No tap holes
Weight:	135 KG
Water Capacity:	200 L

\*All measurements and sizes are approximate.

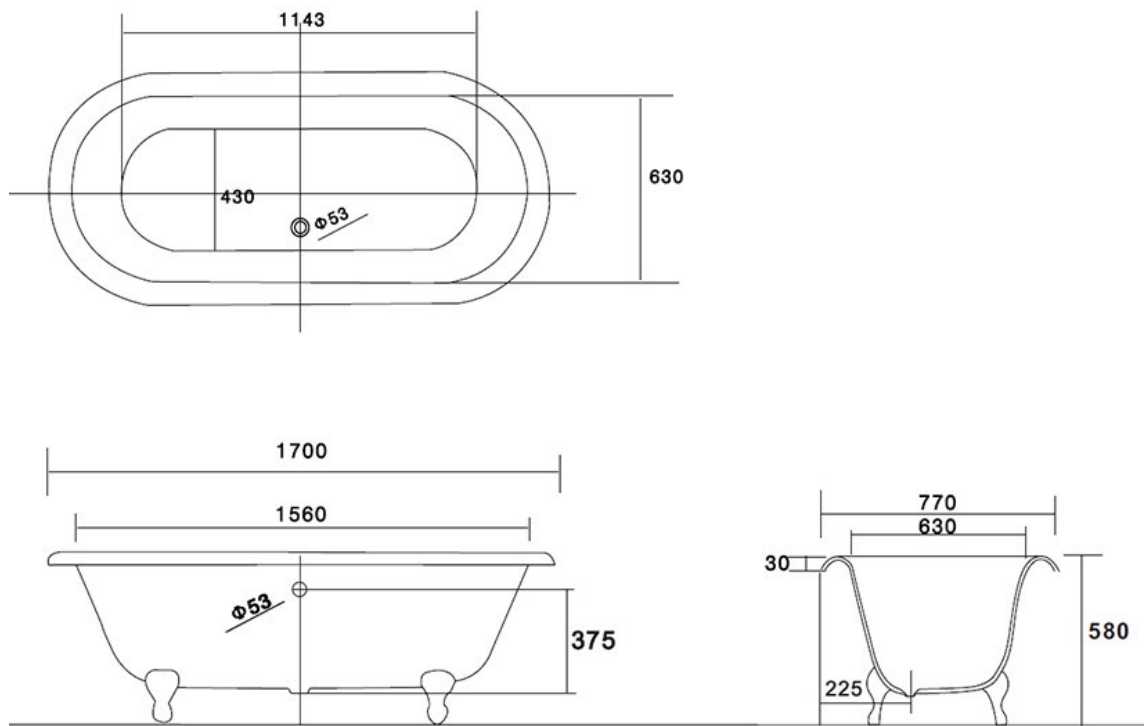

**B-89 (1900) THE MOULIN TECHNICAL SPECIFICATION**

BATHTUB	
Size:	1900 × 770 × 450 mm
Material:	Enamelled cast iron
Standard Finish:	White Primer Exterior
Finish Options:	RAL or Colour Match
Feet:	Chrome - Options Available
Options:	Two tap holes / No tap holes
Weight:	145 KG
Water Capacity:	235 L

\*All measurements and sizes are approximate.

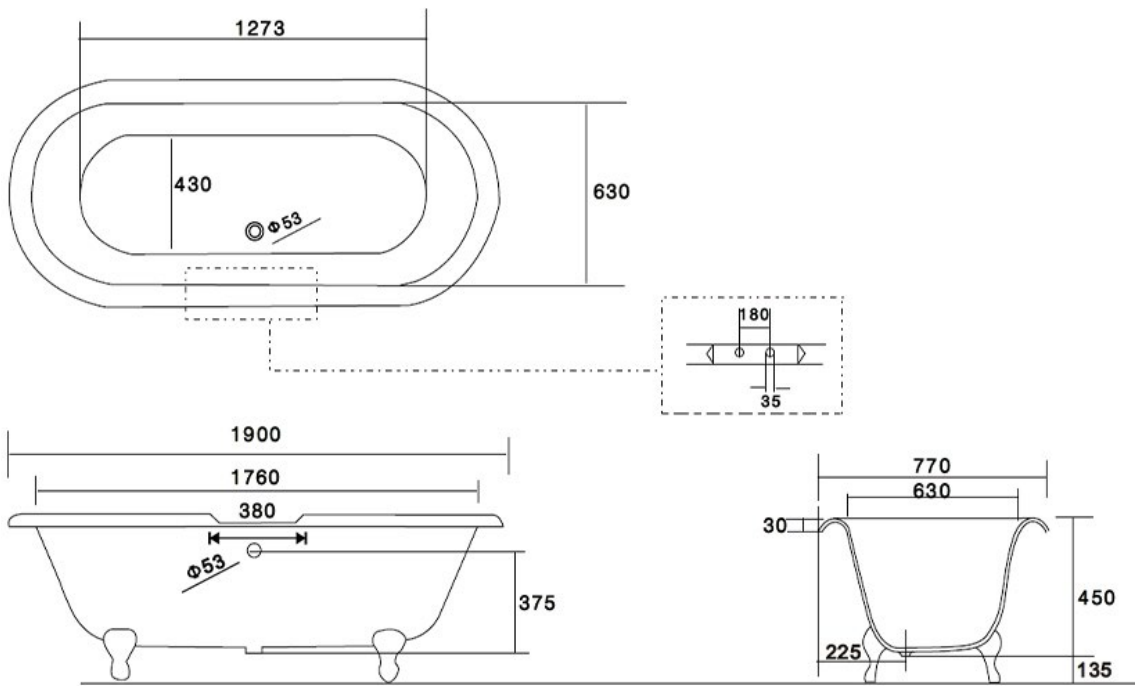







**B-89-1** THE CHEVERNY

Sink into this deep and luxurious bath and let your worries float away. The Cheverny is a classic roll top, exuding cool luxury and style, its detailed ball and claw feet, gentle contours and deep roll make it a perfect bath for two.



**B-89-1** THE CHEVERNY TECHNICAL SPECIFICATION

BATHTUB	
Size:	1850 × 770 × 745 mm
Material:	Enamelled cast iron
Standard Finish:	White Primer Exterior
Finish Options:	RAL or Colour Match
Feet:	Chrome - Options Available
Options:	Two tap holes / No tap holes
Weight:	190 KG
Water Capacity:	285 L

\*All measurements and sizes are approximate.

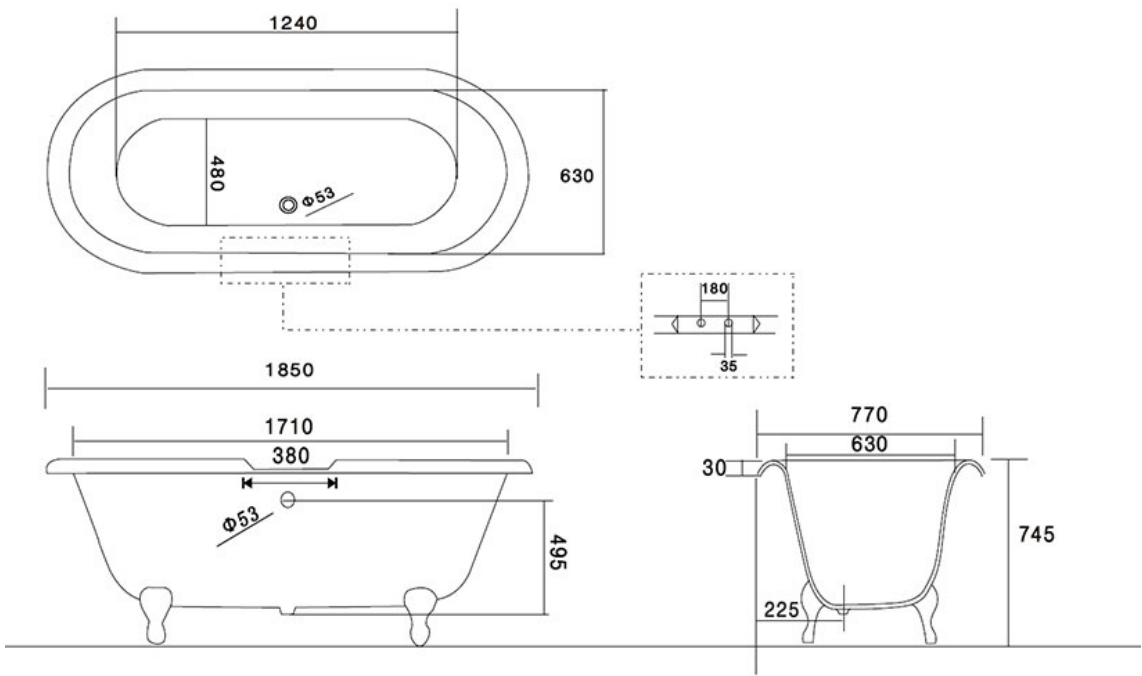



**B-89-1** THE CHEVERNY





**B-76-1** THE LYON

Our most traditional bath is based on the bateau style that was originally made from copper in 18th and 19th century France.

The Lyon’s proportions are designed for maximum comfort and total relaxation. A painted exterior looks stunning in contemporary and traditional bathrooms.



**B-76-1** THE LYON TECHNICAL SPECIFICATION

BATHTUB	
Size:	1700 × 720 × 725 mm
Material:	Enamelled cast iron
Standard Finish:	White Primer Exterior
Finish Options:	RAL or Colour Match
Options:	No tap holes
Weight:	200 KG
Water Capacity:	215 L

\*All measurements and sizes are approximate.

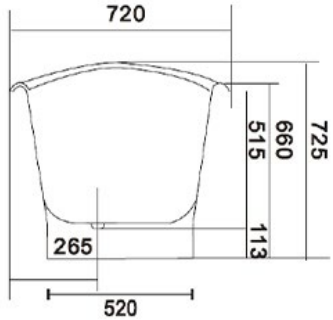
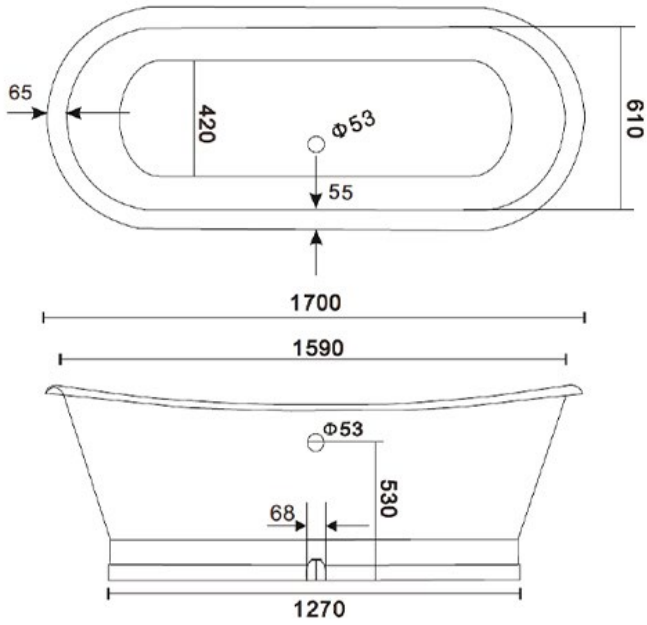



B-76-1 THE LYON





**B-71** THE VERSAILLES

This Art Deco style plinth bath is similar to the Chaumont but has a gradual curve to the roll. Its sleek lines look sumptuous in any kind of interior style.

Generous and comfortable, it provides a wonderful way to unwind and has more than enough room for two.



**B-71** THE VERSAILLES TECHNICAL SPECIFICATION

BATHTUB	
Size:	1800 × 790 × 650 mm
Material:	Enamelled cast iron
Standard Finish:	White Primer Exterior
Finish Options:	RAL or Colour Match
Options:	Two tap holes / No tap holes
Weight:	193 KG
Water Capacity:	255 L

\*All measurements and sizes are approximate.

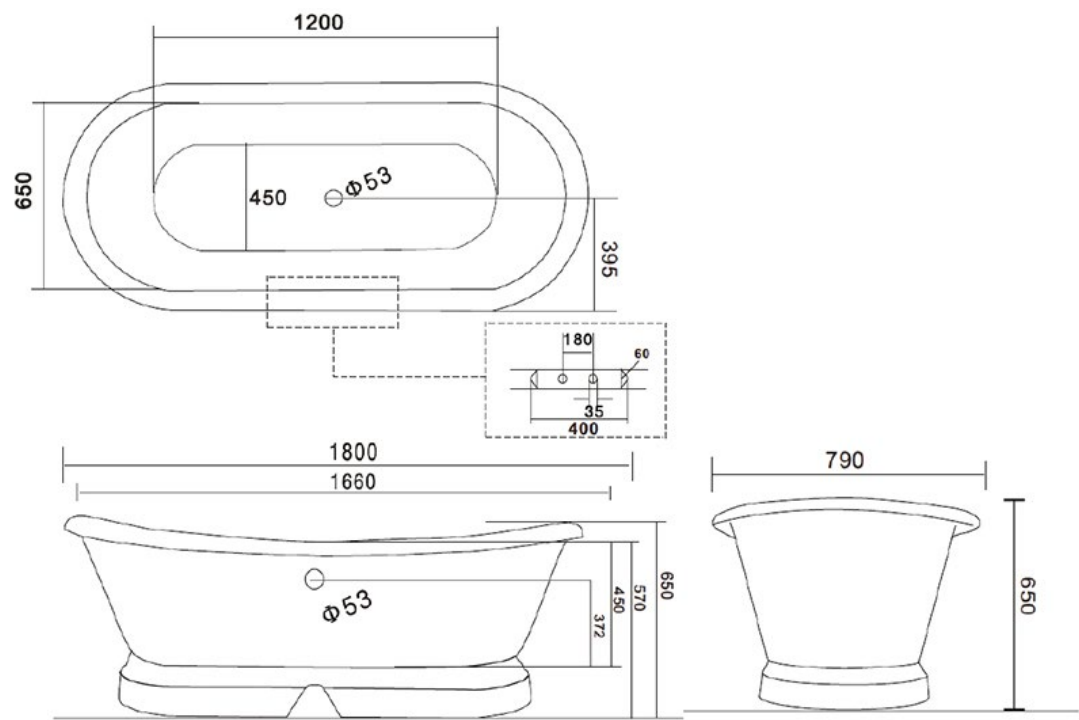



**B-71** THE VERSAILLES





**B-83** THE VILLANDRY

The Villandry double slipper bath is the ultimate expression of bathroom luxury.

A glamorous bath that hints at a more hedonistic period, it brings all the drama and splendour of a 19th century French chateau to modern and traditional bathrooms. Plenty of space for two, The Villandry also comes with distinguished lion's paw feet.



**B-83** THE VILLANDRY TECHNICAL SPECIFICATION

BATHTUB	
Size:	1820 × 762 × 785 mm
Material:	Enamelled cast iron
Standard Finish:	White Primer Exterior
Finish Options:	RAL or Colour Match
Feet:	Chrome - Options Available
Options:	Two tap holes / No tap holes
Weight:	142 KG
Water Capacity:	190 L

\*All measurements and sizes are approximate.

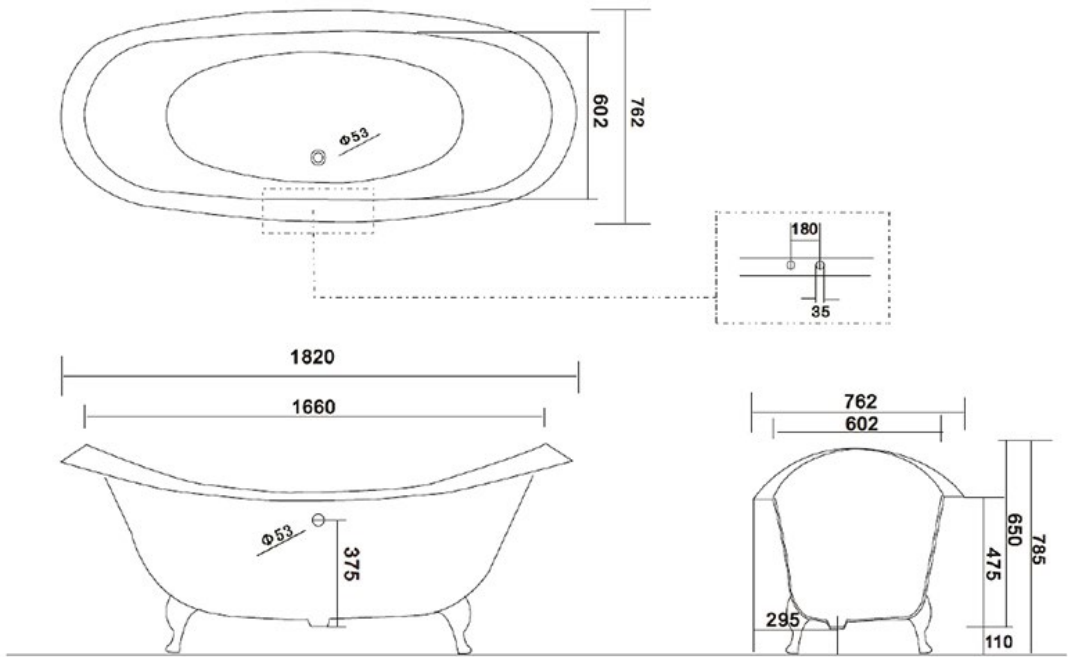







APB-70 / APB-70 (1470) THE AMBROSE

The Ambrose Tub is the smallest of our range, however it packs a punch with its minimalist but sophisticated design.

The ornate feet provide a subtle but eye-catching feature.



APB-70 THE AMBROSE TECHNICAL SPECIFICATION

BATHTUB	
Size:	1370 x 740 x 740 mm
Material:	Enamelled cast iron
Standard Finish:	White Primer Exterior
Finish Options:	RAL or Colour Match
Feet:	Chrome - Options Available
Options:	No tap holes
Weight:	130 KG
Water Capacity:	160 L

\*All measurements and sizes are approximate.

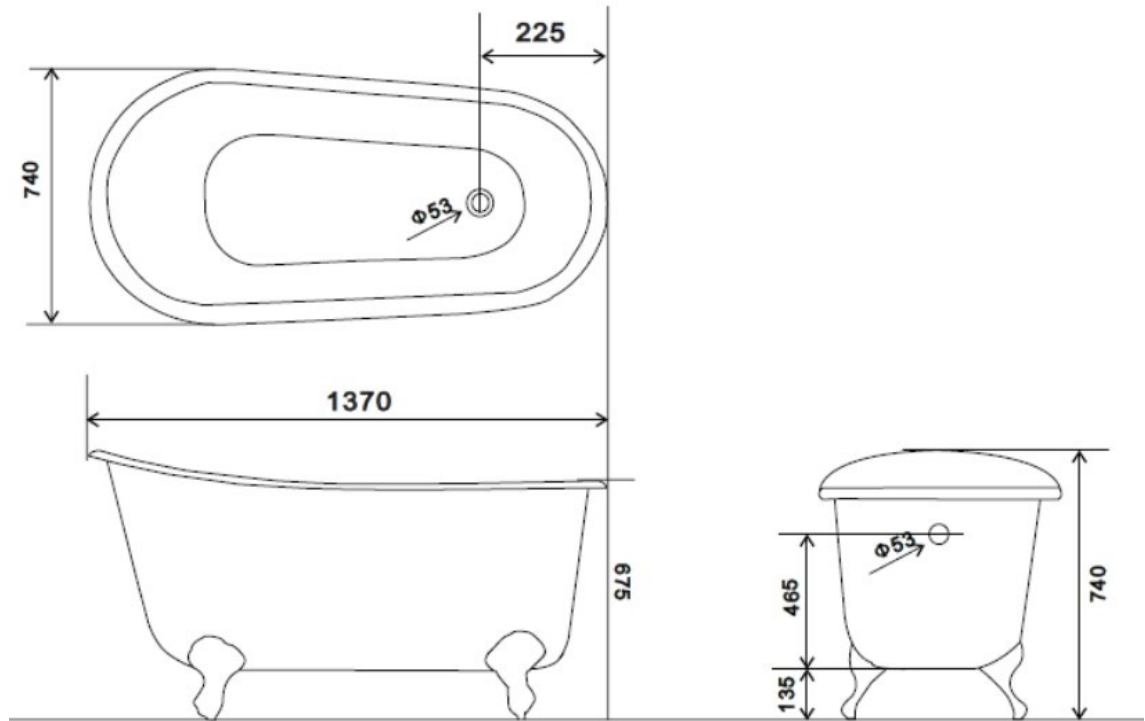

APB-70 (1470) THE AMBROSE TECHNICAL SPECIFICATION

BATHTUB	
Size:	1470 x 740 x 740 mm
Material:	Enamelled cast iron
Standard Finish:	White Primer Exterior
Finish Options:	RAL or Colour Match
Feet:	Chrome - Options Available
Options:	No tap holes
Weight:	140 KG
Water Capacity:	175 L

\*All measurements and sizes are approximate.

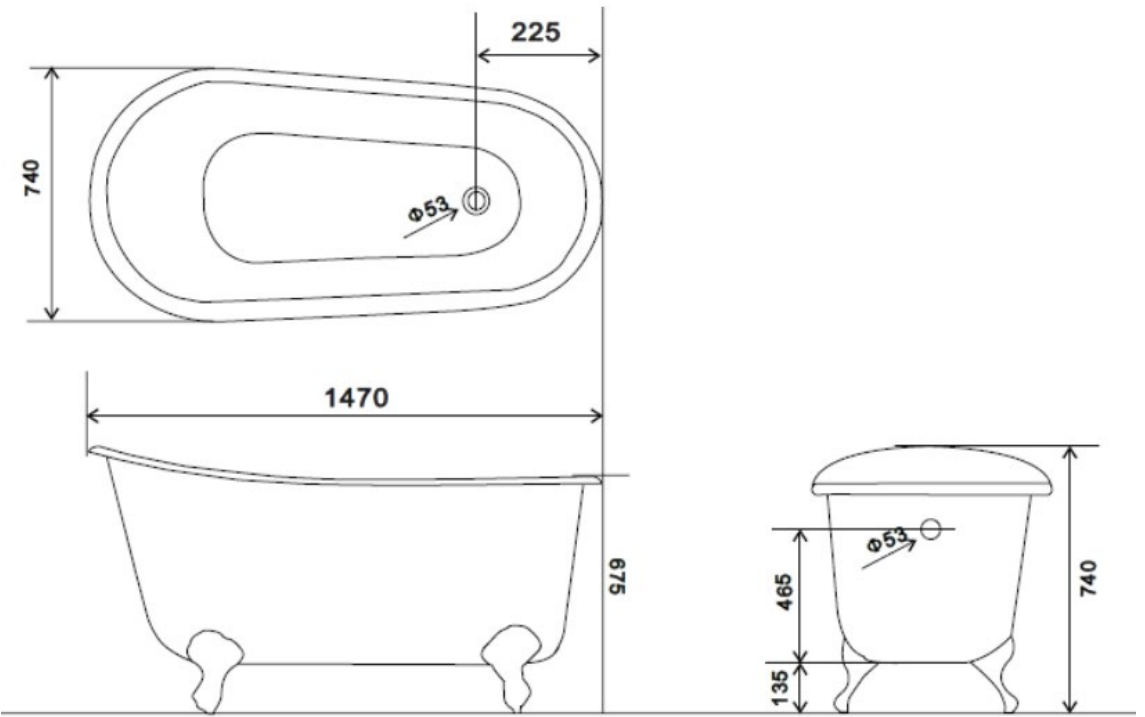



APB-70 / APB-70 (1470) THE AMBROSE







TOWEL  
RADIATORS



**DECORATIVE TOWEL RAIL** BRUSHED BRASS / COPPER / CHROME  
**COLUMN TOWEL RAIL** BRUSHED BRASS / COPPER / CHROME

Our range of Towel Rails come in 3 different colours - Brushed Brass, Copper and Chrome. The choice of inserts can be either the column (Neo-Classic 4 Column) or the decorative (Rococo 1 Column) and they can be finished in any of our finishes , giving you true flexibility when designing your bathroom.

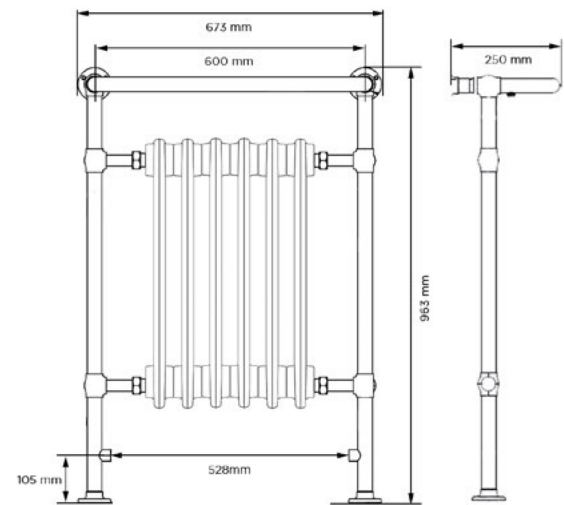

NEO-CLASSIC 4 COLUMN TOWEL RADIATOR

TOWEL RADIATOR DIMENSIONS	
Height:	963 mm
Length:	673 mm
Floor to Valve intake:	105 mm
Valve Intake to Valve Intake:	528 mm
Depth:	250 mm
Pipe Centres to Skirting:	100 mm
HEAT OUTPUT	
Delta ΔT 50°C:	557 Watts / 1900 BTUs
Delta ΔT 60°C:	705 Watts / 2407 BTUs
WEIGHT	
Total Weight:	31.1 KG

\*All measurements and sizes are approximate.

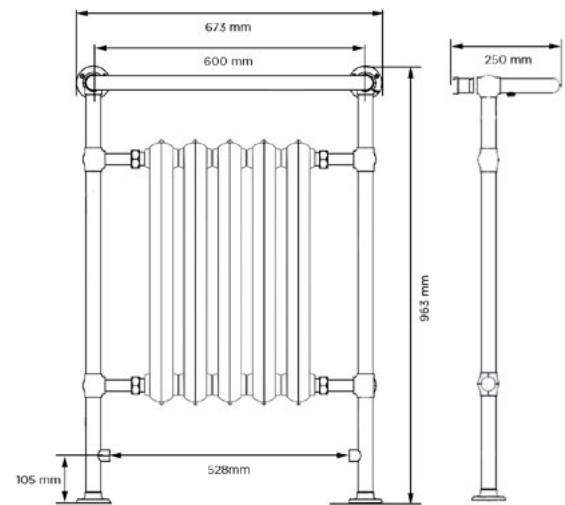

ROCOCO 1 COLUMN TOWEL RADIATOR

TOWEL RADIATOR DIMENSIONS	
Height:	963 mm
Length:	673 mm
Floor to Valve intake:	105 mm
Valve Intake to Valve Intake:	528 mm
Depth:	250 mm
Pipe Centres to Skirting:	100 mm
HEAT OUTPUT	
Delta ΔT 50°C:	520 Watts / 1776 BTUs
Delta ΔT 60°C:	659 Watts / 2250 BTUs
WEIGHT	
Total Weight:	35.2 KG

\*All measurements and sizes are approximate.



Column Towel Radiator in Copper with Farrow & Ball Pitch Black Colour Match Insert



Column Towel Radiator in Chrome with RAL 9010 Insert



Column Towel Radiator in Brushed Brass with Farrow & Ball Railings Colour Match Insert



Decorative Towel Radiator in Copper with Aged Bronze Insert



Decorative Towel Radiator in Brushed Brass with Black & Gold Burnish Insert



Decorative Towel Radiator in Chrome with Aged Silver Insert

# ACCESSORIES

ALL MEASUREMENTS AND SIZES  
ARE APPROXIMATE AND SHOULD  
ONLY BE USED AS A GUIDE WITH A  
TOLERANCE LEVEL OF +/- 4MM.

## BATH WASTE KITS



Brass bathtub drain, overflow pipe, brass  
plug with chain - Chrome finish

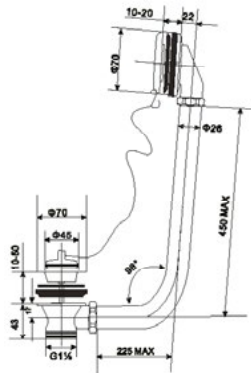

**B-1044** EXPOSED CHROME BATH WASTE

## SEAL TRAP



Brass with Chrome finish

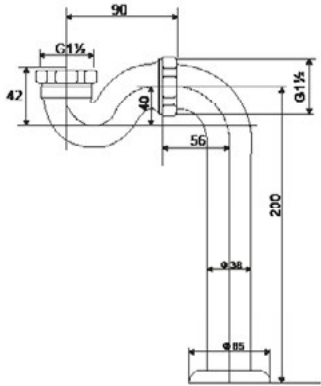

**B-1053** CHROME SHALLOW SEAL TRAP

## PIPE SHROUDS



Brass with Chrome finish

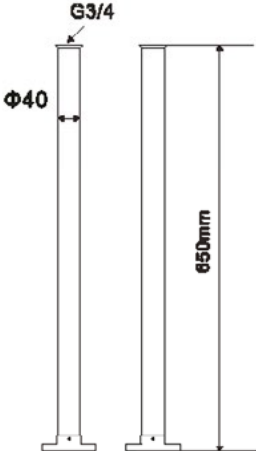

**B-610** FREESTANDING PIPE SHROUD



Brass with Chrome finish

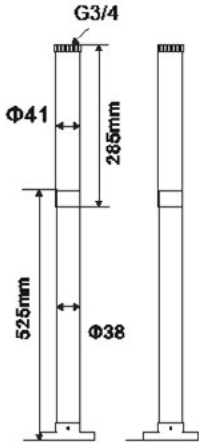

**B-610B** EXPOSED CHROME TELESCOPIC PIPE SHROUD

## BATH TAPS



Chrome finish

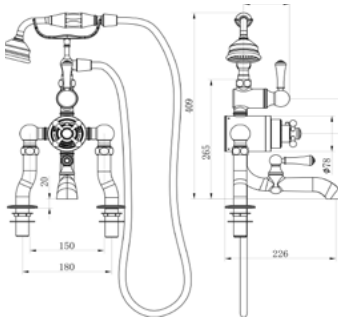

**TR-BT-UK16** TRADITIONAL CHROME THERMOSTATIC BATH TAPS









**Arroll**  
6 Longlands Avenue,  
Newtownabbey,  
Co.Antrim, BT36 7NE  
Northern Ireland

Tel: +44 (0) 28 9036 5725  
info@arroll.co.uk

**www.arroll.co.uk**

ALL IMAGES ARE INCLUDED FOR REPRESENTATION.  
MODEL DETAILS MAY CHANGE.